

Water Ripple design makes the whole space transparent, reflecting the depth changes under the light, deepening the spatial layering.

MAIN ASSEMBLY ▾

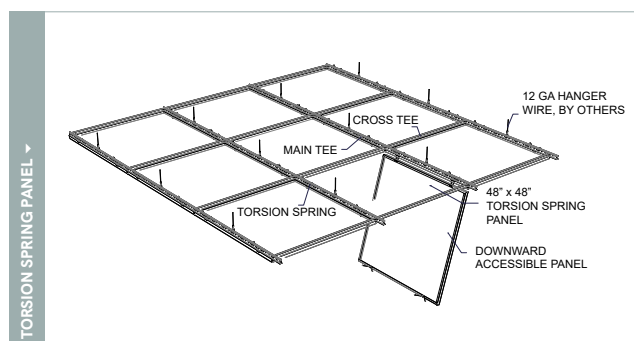
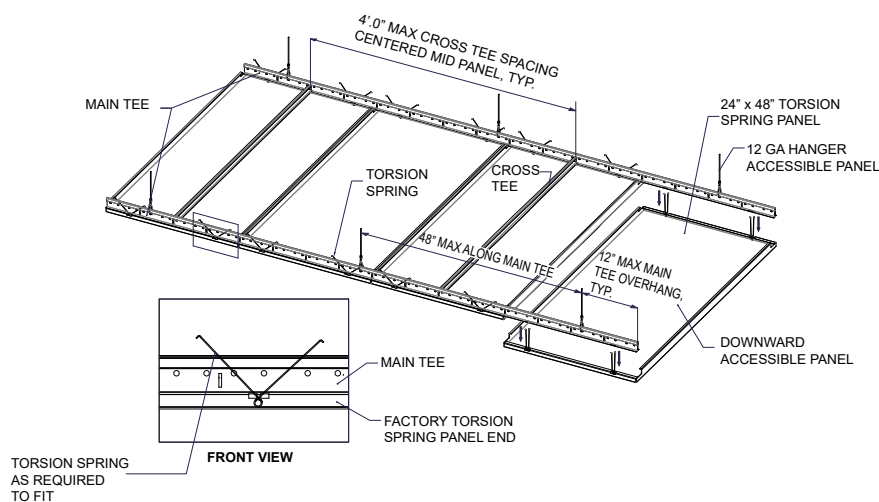

PHYSICAL DATA

- Material substrate – Stainless Steel
 - ▶ 304, 316, 316L & more
- Thickness: 0.6~3.0 mm design dependent
- The main body of the water ripple stainless steel panel is integrated with the colored layer to maintain the basic structure and basic properties of the original stainless steel, processed by conventional molding and drawing.
- Weight – Varies from 1.0-3.0 lbs./sq.ft.
- Warranty – One Year Limited
- Seismic areas – Water Ripple panels have been engineered for use in all seismic areas. Installations may require additional attachment from panel to suspension bar. Check with local code officials or a licensed engineer for additional requirements.

SUSTAINABILITY

LEED CONTRIBUTION – STAINLESS STEEL

- Stainless steel is a durable, long-lasting material that is 100% recyclable. It contains a high percentage of recycled content and requires minimal maintenance.

LEED® is a registered trademark of the U.S. Green Building Council

FEATURES

- The water ripple design makes the whole space transparent, reflecting the depth changes under the light, deepening the spatial layering.
- Superior acid & alkali resistance, with no bubbles and no pinholes.
- Colors: silver, champagne, copper, black & blue.
- Custom sizes & shapes – At Maxxit custom is what we do best. We will make any shape or size you can design.
- Standard sizes – in addition to custom we also have standard products available made to order.
 - ▶ 2' x 2' panel
 - ▶ 2' x 4' panel
 - ▶ 3' x 3' panel
- Versatile attachment options for 15/16" HD grid include; lay-in and torsion spring designs.
- Easy plenum access – Torsion spring design offers downward accessibility.
- Pre-assembled & easy to install.
- Cleanable using CDC recommended and EPA-approved disinfectants for fog, spray & wipe.
- Integrated lighting options available.

STAINLESS STEEL FINISHES

Colors

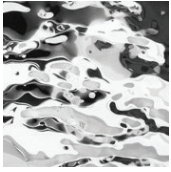

Silver

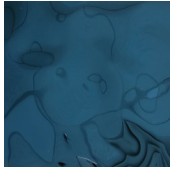

Blue

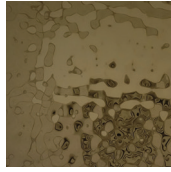

Champagne

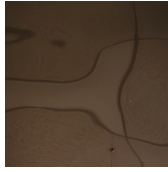

Copper

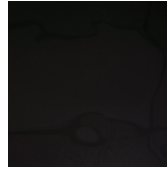

Black

Textures

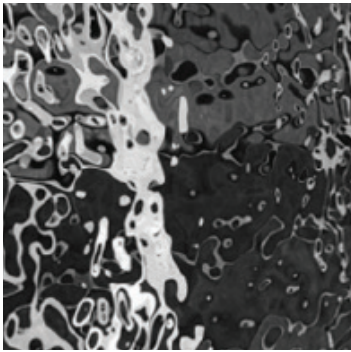

Soft #2

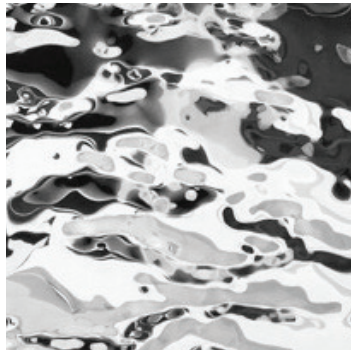

Flow

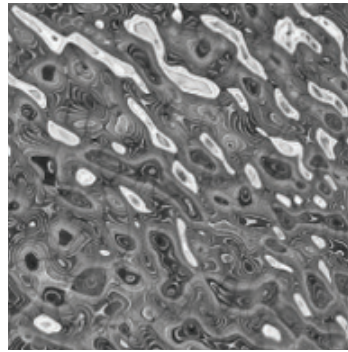

Ripple #2





PANEL:Form™ DESIGNS

BACKLIT
Ceiling



BACKLIT
Walls



CANOPY PARTITIONS



CONCAVE



DIMENSIONAL



DESIGN PERFORMED
Ceiling

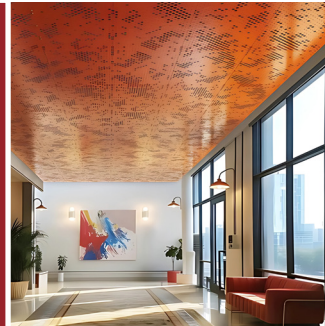

DESIGN PERFORMED
Walls



MESH

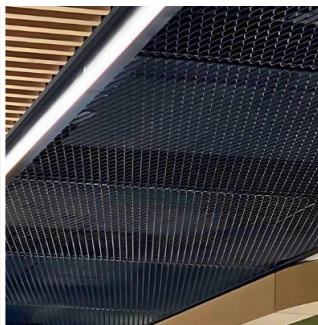

MOZAIX

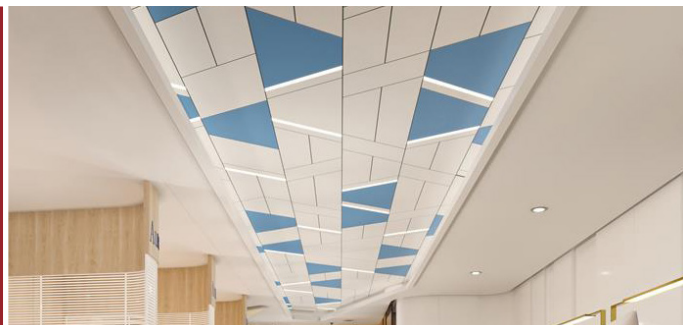

QUIET WALL



RADIUS



SEGMENTED



TRADITIONAL



WATER RIPPLE

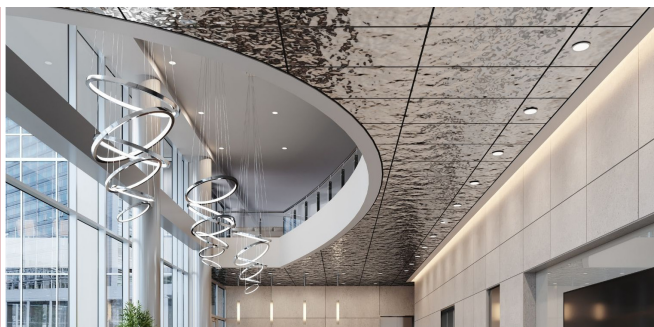

WHERE CREATIVE ENGINEERING MEETS ARCHITECTURAL VISION

At Maxxit, we combine creative engineering, advanced manufacturing, and close collaboration to help architects and designers bring bold ideas to life. From standard to custom solutions, we turn imagination into precision-built reality.

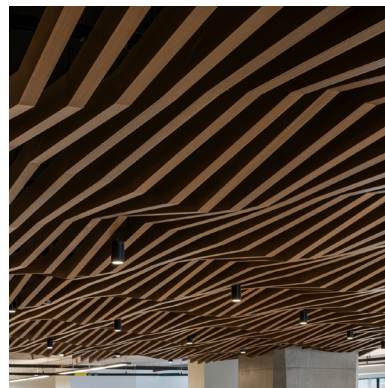

Co:LAB Studio

Our custom design service empowers architects and designers to realize unique visions through tailored solutions, material innovation, and expert collaboration — turning bold ideas into architectural realities.