

# LINE:Form Linear Planks - Installation Instructions

---

## General Information

- LINE:Form linear planks are horizontal, fabricated aluminum profiles made from .041" - .060" thick aluminum sheet, design dependent.
- These ceilings are offered in lengths up to 12', widths up to 8" and depth up to 1".
- Easy installation and plenum access - planks snap in and out of carrier system.
- Metal Ceilings are engineered for use in seismic areas when installed in accordance with local code requirements.

## Site Conditions

- Planks not to be used in exterior applications or high moisture environments where water comes in direct contact with the plank.
- Install only after spaces are enclosed and weather-tight, and after all wet work and overhead work have been completed.

## Storage & Handling

- Do not store or install near an exposed flame, source of heat, or source of ignition.
- Store horizontally in the original carton in a dry, interior space. Clean gloves must be used to avoid fingerprints. When removed for install, should be stored in a flat, horizontal position.
- Recommended that two people install each 8' plank.

## Fire Performance

- Manufactured to meet ASTM E-84 Class 1 or A fire retardancy. Planks may interfere with fire sprinkler or fire detection system. Consult a fire protection engineer, NFPA 13, and their local code official for guidance on the proper installation.

## Warranty

- A 1-year limited warranty is available. Please consult [www.maxxitgroup.com](http://www.maxxitgroup.com) for details.

## Colors

- Made with a factory-applied polyester paint. Available in Standard Colors, Color Matched and Wood Look powder-coated and film.

- To maximize visual consistency, planks should be unpacked and examined collectively to determine the most desirable arrangement for installation.

## Cutting Planks

- LINE:Form planks are made of aluminum that can be cut with commonly available tools.
- Cut the planks using standard wood working tools and, where possible, a straight edge. A table saw is recommended for straight cuts and a band saw for curved cuts. In general, these practices will be typical of those employed in finish carpentry.
- Circular saws should use a multi-purpose blade. For best finished cut quality use a straight edge guide and maintain a constant feed rate. Stop the blade motion before backing the saw out of the cut.

# LINE:Form Linear Planks - Installation Instructions

1

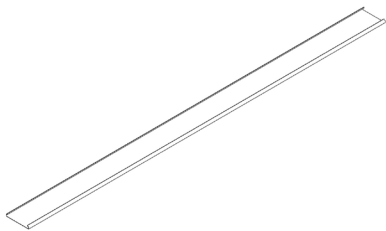

2

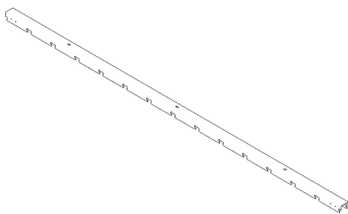

3

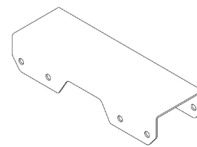

4

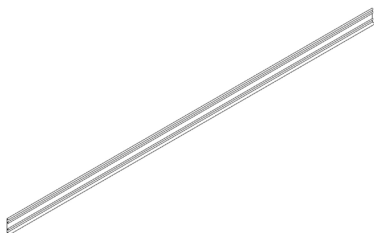

5

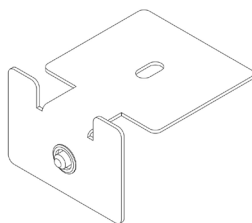

ITEM NO	DESCRIPTION
1	LINEAR PLANK
2	SUSPENSION RAIL
3	SUSPENSION RAIL JOINER
4	PERIMETER MOULDING
5	PERIMETER BRACKET A

# LINE:Form Linear Planks - Installation Instructions

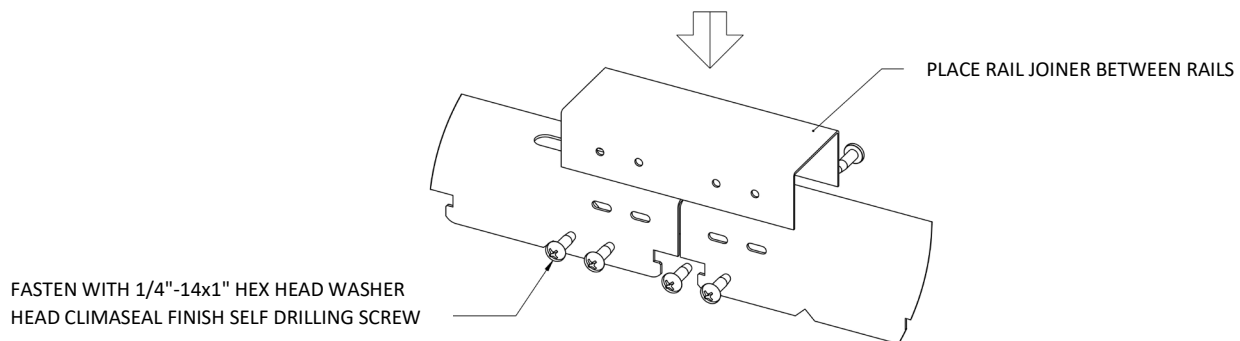
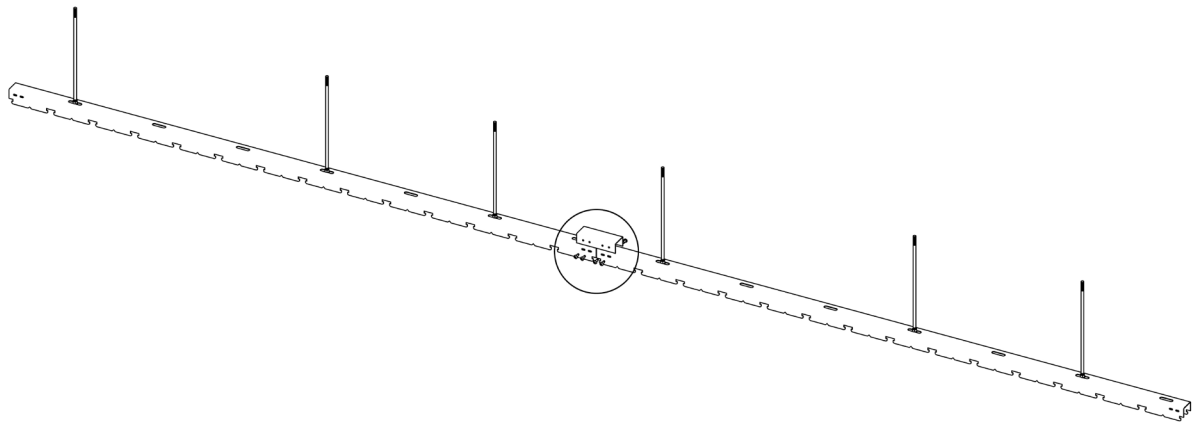
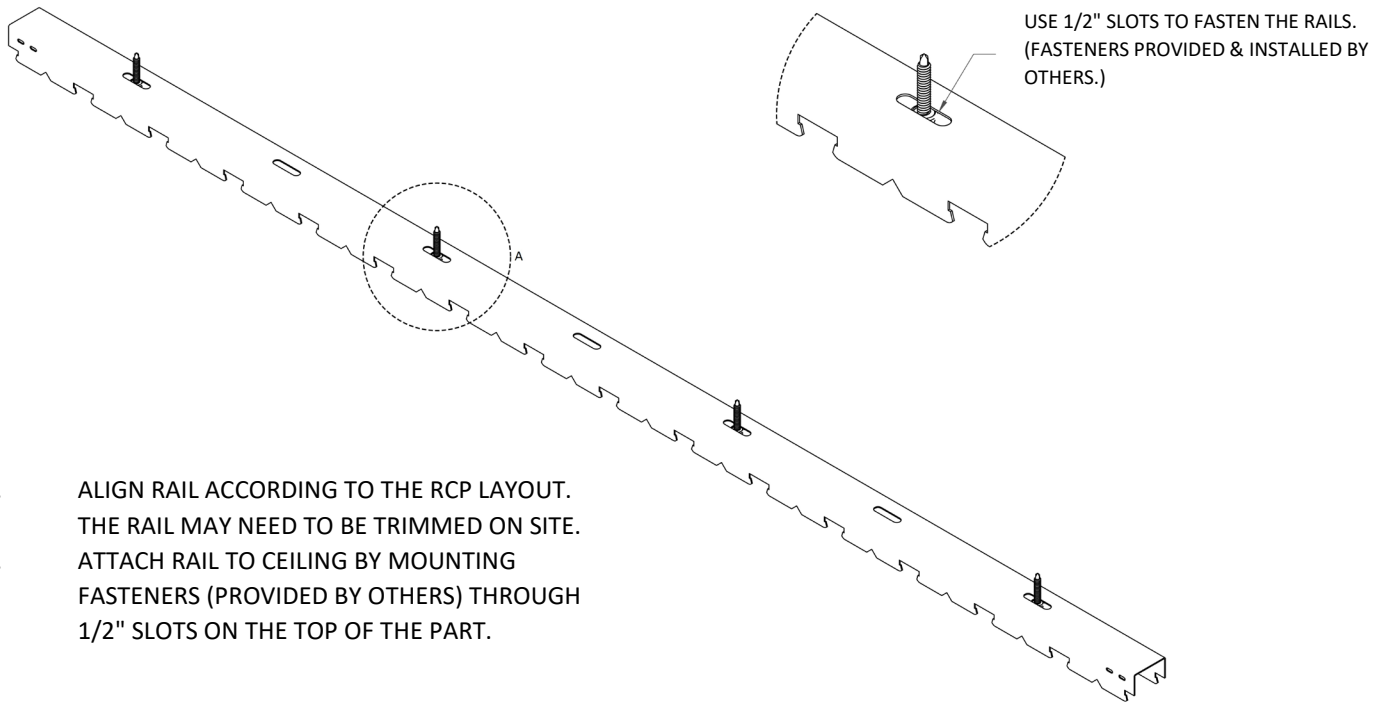

# LINE:Form Linear Planks - Installation Instructions

---

## PLANK STARTING POSITION

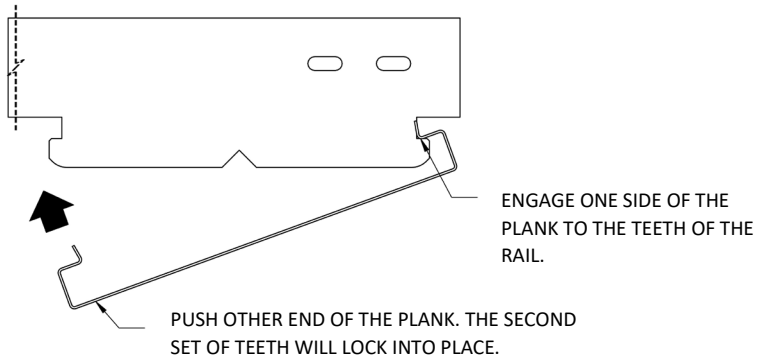

## PLANK END POSITION

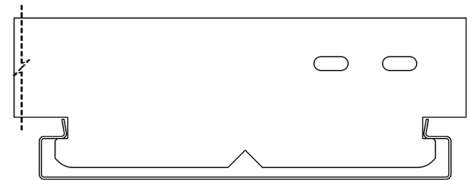

TO REMOVE PLANK, APPLY PRESSURE TO THE MIDDLE AND PULL ONE END OVER THE RAIL TEETH

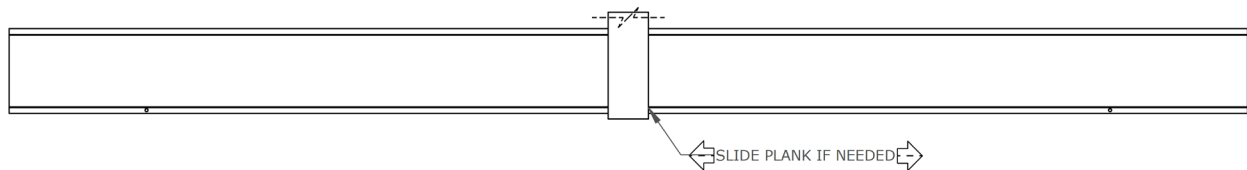

# LINE:Form Linear Planks - Installation Instructions

---

## MEP Integrations

- Mechanical fixtures such as lights and sprinklers can be installed at the suspension system height, flush with the planks, or below the planks. Fixture weight must not be supported by the grid suspension.

Before installing, please note.

In addition to these instructions please refer to the publications referenced below for full details on industry accepted practices and requirements.

- CISCA "Ceiling Systems Handbook"
- Standard for Ceiling Suspension System Installations - ASTM C 636
- Standard for Ceiling Suspension Systems Requiring Seismic Restraint - ASTM E 580
- IBC (International Building Code) Standard for Seismic Zone for local area.

## For addition question or assistance

Please contact us at: [www.maxxitgroup.com](http://www.maxxitgroup.com)